

Parts List			
Item	Qty	Parts No.	Description
1	3	371828	M4x16 POZI PN HD SCREW Z/P STL
2	1	436991	FLAP SHAFT
3	1	437824	FLAP SHAFT-EXTENDED
4	1	437826	FILTER SUPPORT BRKT
5	1	438070	ACTUATOR CLM4
6	2	438071	BEARING - MOSS 1092530000VR
7	1	438240	BYPASS ACTUATOR WARNING LABEL
8	1	439166	FLAP END SUPPORT LHS
9	1	439167	FLAP 2000
10	1	439168	FLAP END SUPPORT RHS
11	3	439923	M4 x 2mm WASHER
12	1	441092	BYPASS SUPPORT BRACKET-2000
13	4	466291	M4 x 10 SCREW POZI PN HD Z/P STL
14	3	487048	M4 INSERT
15	1.65m	68S312	FOAM 3 x 12mm STRIP S/ADH BLACK
16	6	72POP0410	POP RIVET 4mm ALI

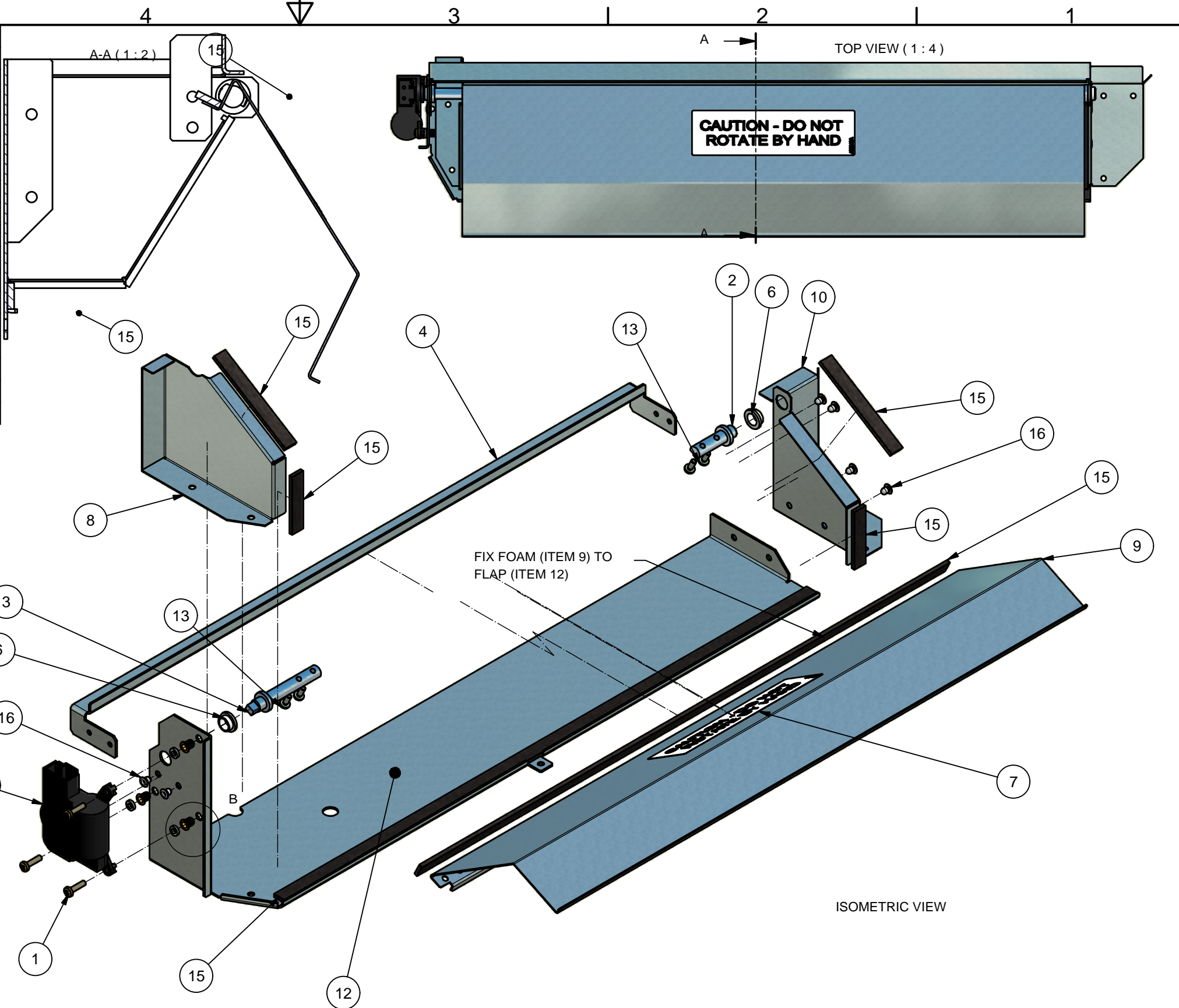

ROTATION ANGLE (END VIEW) (1:2)

DETAIL B ENLARGED

FIX FOAM (ITEM 9) TO FLAP (ITEM 12)

ISOMETRIC VIEW

- NOTES**
1. APPLY SOME LIGHT OIL TO MOSS BEARING 438071 ON ASSEMBLY
 2. CUT FOAM LENGTHS TO SUIT -ENSURING FLAP SEALS WHEN CLOSED
 3. ITEM 8 TO BE SECURED TO ITEM 12 UPON INSTALLATION INTO GENERAL ASSEMBLY

DIMENSIONS IN MILLIMETRES		TOLERANCES:- X		0.5 X.X	0.2 X.XX	0.1	ANGULAR DIMENSIONS	1.0°	UNLESS OTHERWISE SPECIFIED
This drawing/document is COPYRIGHT and the property of VENT-AXIA Ltd. It must not be copied (in whole or in part) used for manufacture or otherwise disclosed without prior written consent of the company. Any copies of this drawing/document made by any method must also include a copy of this legend. © VENT-AXIA LTD 2008				DRAWN M Rudrum MATERIAL FINISH	DATE 25/07/2008 CHK'D PH DATE 10/09/2008	TITLE BYPASS ASSEMBLY		SHT: 1 of 1 ISSUE ECO No DATE 11/09/2008 APVD	
PRODUCT SENT2000HR SCALE AS NOTED				STOCK REF No DRG No 439177		ISSUE B			