

KOMFOVENT KOMPAKT REGO 1200

Technical data

REGO 1200PE-EC (horizontal)

Panel thickness	45 mm
Unit weight	120 kg
Nominal air flow	1200 m ³ /h
Supply voltage	3~ 400/50 V/Hz
Maximal operating current	8,7 A
Control system	KOMFOVENT C3

REGO 1200PE-EC

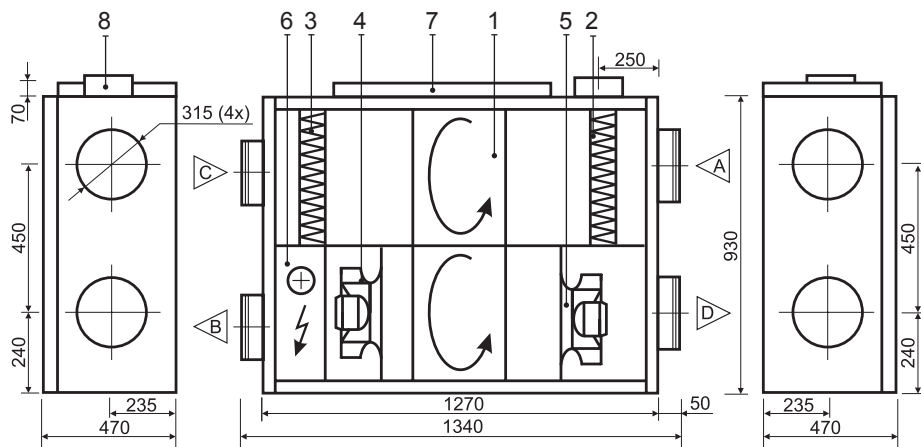

Design:

- | | |
|------------------------------|------------------|
| 1. Rotary heat exchanger | A Outdoor intake |
| 2. Supply air filter | B Supply air |
| 3. Exhaust air filter | C Extract indoor |
| 4. Supply fan | D Exhaust air |
| 5. Exhaust fan | |
| 6. Electric air heater | |
| 7. Automatic control devices | |
| 8. Main switch | |

Thermal Efficiency (1200 m³/h)

Parameters	Supply				Exhaust	Unit
Intake						
Temperature	-15	-10	-5	0	20	°C
Relative humidity	82	82	82	82	45	%
Supply						
Temperature	10	11,4	12,8	14,3		°C
Relative humidity	65	62	14,3	40		%

Acoustic Data

Supply air flow (into air ducts)	Unit	
Intake	66	Lwa dB(A)
Supply	77	
Exhaust air flow (into air ducts)		
Intake	66	Lwa dB(A)
Supply	77	
Surrounding	51	Lp3 dB(A)

Parameters	Supply	Exhaust	Unit
Nominal air flow	1200	1200	m ³ /h
Air Filters			
Filter class	F5/F7	F5/F7	
Type	Panel	Panel	
Dimensions bxxhxl	410x420x46	410x420x46	mm
Fans Motors			
Type	EC	EC	
Input power	425	425	W
Rotation speed	2725	2725	rpm
Protection level	IP 54	IP 54	IEC 34-5
Rotary Heat Exchanger			
Thermal efficiency	71,3		%
Energy recovery	12,1		kW
Air temperature in/out	-23/7,7	20/-10,6	°C
Relative humidity in/out	82/74	40/98	%
Electric Air Heater			
Capacity	4		kW
Air temperature in/out	7,7/17,8		°C
There is an option to connect hot water duct air heater.			

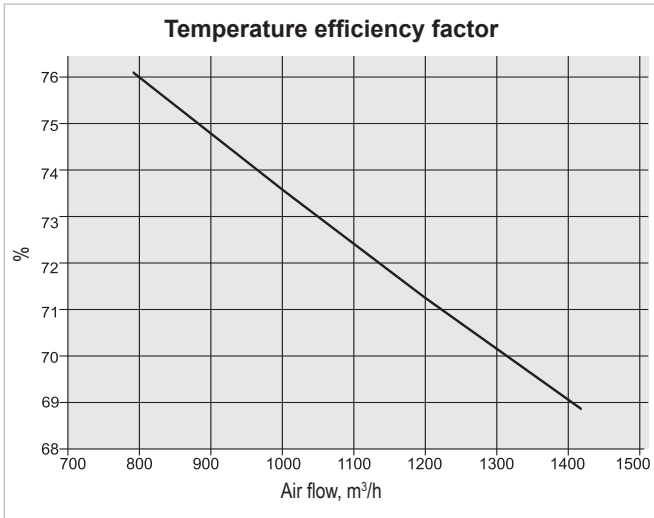

Performance REGO 1200PE-EC

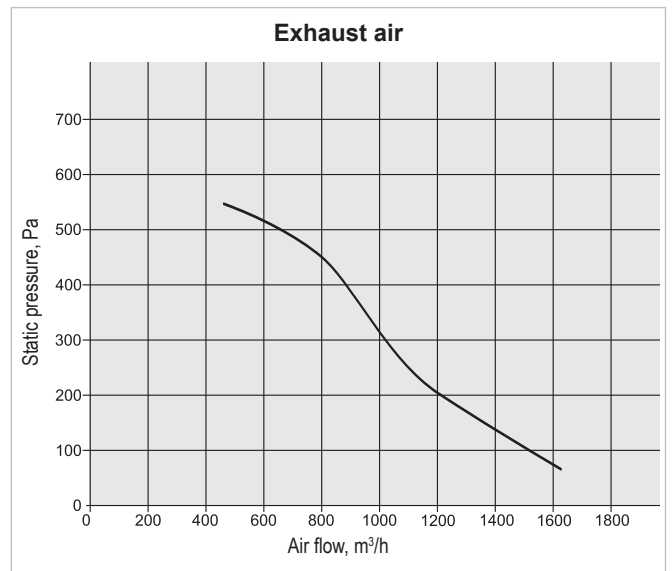
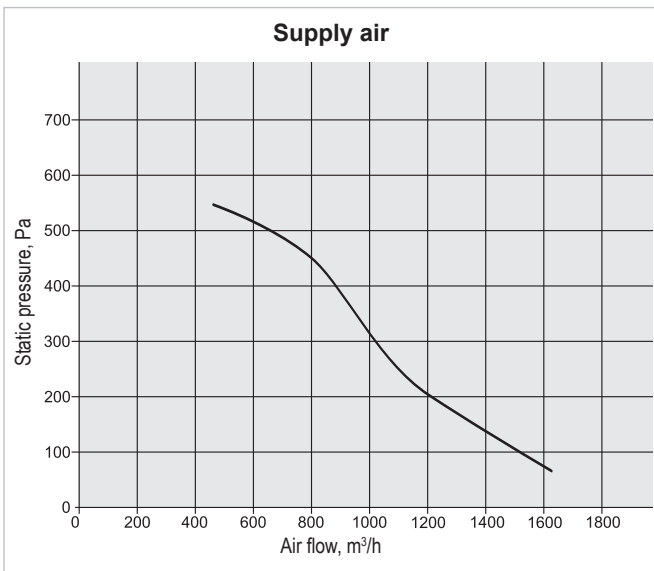

Correction factor for F7 class filter approximately – 70 Pa.