

KOMFOVENT KOMPAKT REGO 400

Technical data

REGO 400HE-EC (horizontal)

Panel thickness	45 mm
Unit weight	48 kg
Nominal air flow	400 m ³ /h
Supply voltage	1~ 230/50 V/Hz
Maximal operating current	5,7 A
Control system	KOMFOVENT C3

REGO 400HE-EC

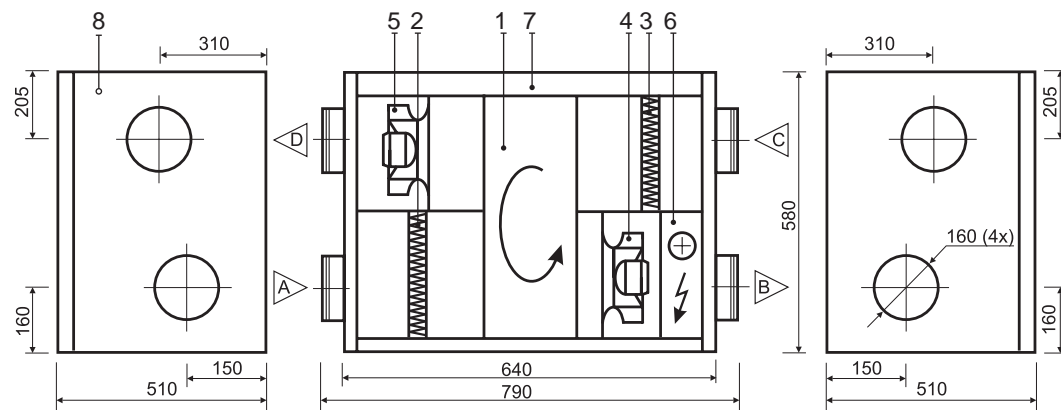

Design:

- | | |
|------------------------------|------------------|
| 1. Rotary heat exchanger | A Outdoor intake |
| 2. Supply air filter | B Supply air |
| 3. Exhaust air filter | C Extract indoor |
| 4. Supply fan | D Exhaust air |
| 5. Exhaust fan | |
| 6. Electric air heater | |
| 7. Automatic control devices | |
| 8. Main cable (L = 1,5 m) | |

Thermal Efficiency (400 m³/h)

Parameters	Supply				Exhaust	Unit
Intake						
Temperature	-15	-10	-5	0	20	°C
Relative humidity	82	82	82	82	45	%
Supply						
Temperature	12,7	13,8	14,8	15,8		°C
Relative humidity	53,4	47,2	41,4	38,1		%

Acoustic Data

Supply air flow (into air ducts)	Unit	
Intake	52	L _{WA} dB(A)
Supply	60	
Exhaust air flow (into air ducts)		
Intake	52	L _{WA} dB(A)
Supply	60	
Surrounding	46	L _{p3} dB(A)

Parameters	Supply	Exhaust	Unit
Nominal air flow	400	400	m ³ /h
Air Filters			
Filter class	F5	F5	
Type	Panel	Panel	
Dimensions b x h x l	410x200x46	410x200x46	mm
Fans Motors			
Type	EC	EC	
Input power	79	79	W
Rotation speed	3160	3160	rpm
Protection level	IP 44	IP 44	IEC 34-5
Rotary Heat Exchanger			
Thermal efficiency	79,2		%
Energy recovery	4,6		kW
Air temperature in/out	-23/11,1	20/-14,1	°C
Relative humidity in/out	82/64	45/99	%
Electric Air Heater			
Capacity	1		kW
Air temperature in/out	11/21		°C

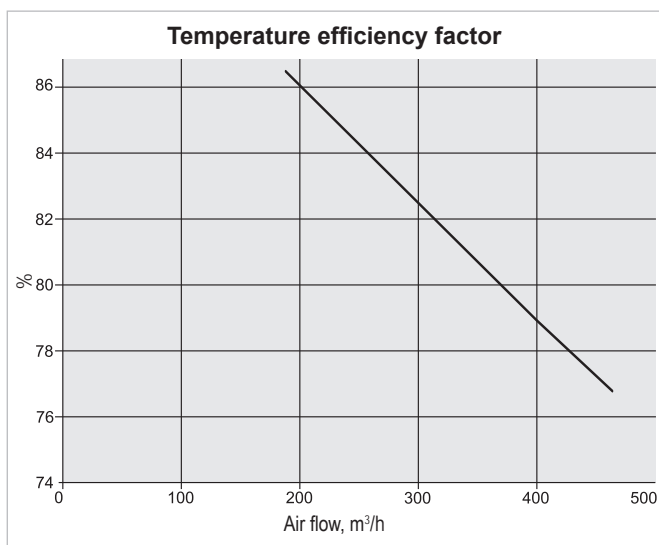

Performance REGO 400HE-EC

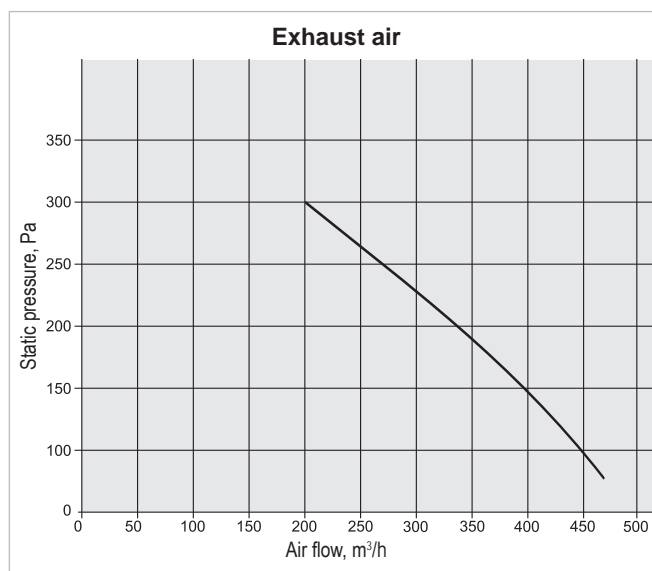
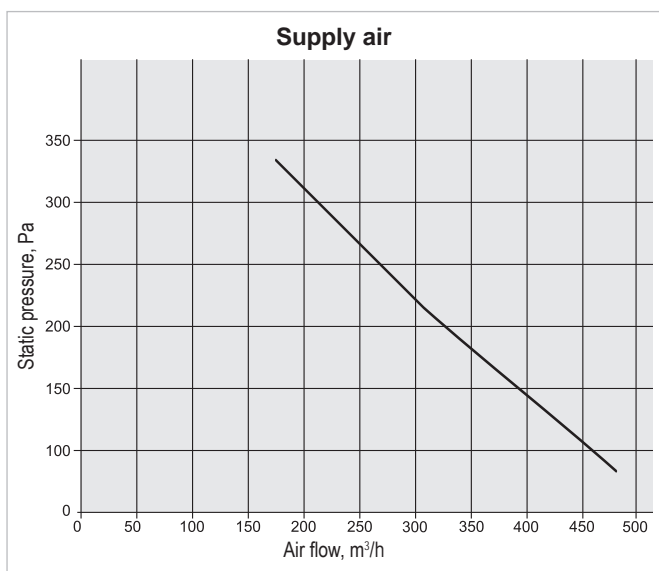

Correction factor for F7 class filter approximately – 70 Pa.