

KOMFOVENT KOMPAKT RECU 3000

Technical data

RECU 3000HE (horizontal)

Panel thickness	45 mm
Unit weight	530 kg
Nominal air flow	3000 m ³ /h
Supply voltage	3~ 400/50 V/Hz
Maximal operating current	34,7 A
Control system	KOMFOVENT C3

RECU 3000HW (horizontal)

Panel thickness	45 mm
Unit weight	540 kg
Nominal air flow	3000 m ³ /h
Supply voltage	3~ 400/50 V/Hz
Maximal operating current	9,1 A
Control system	KOMFOVENT C3

RECU 3000HE

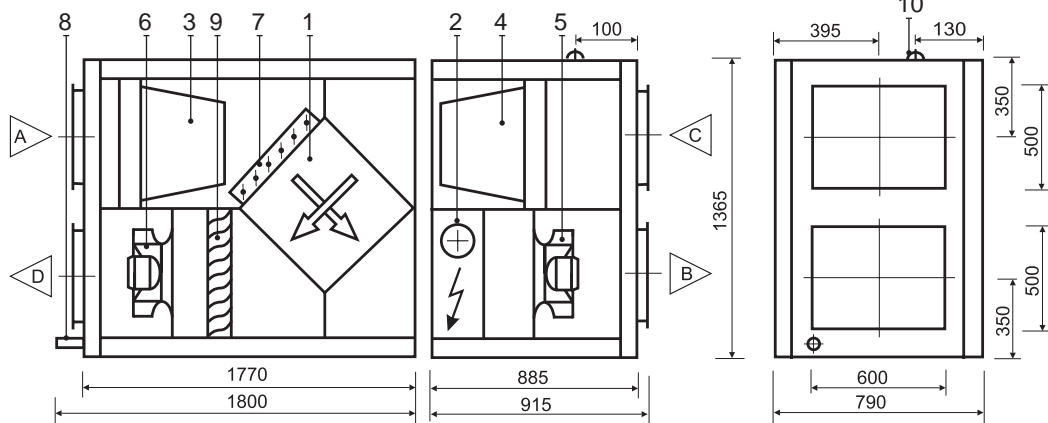

RECU 3000HW

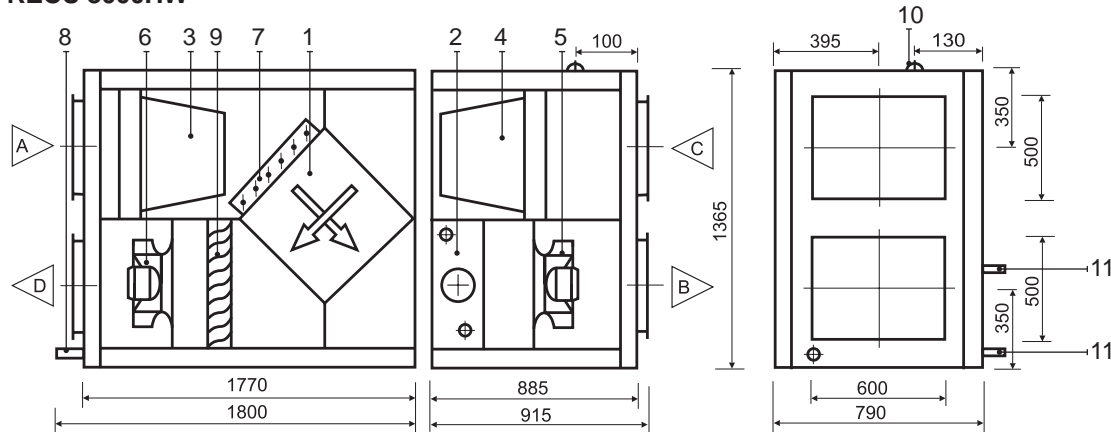

- A Outdoor intake
- B Supply air
- C Extract indoor
- D Exhaust air

Design:

1. Plate heat exchanger
2. Electric or hot water air heater
3. Supply air filter
4. Exhaust air filter
5. Supply fan
6. Exhaust fan
7. Air by-pass damper
8. Condensate drain (the water trap must be installed)
9. Drop eliminator
10. Connection of main cable
11. Fluid connection tube

Thermal Efficiency (3000 m³/h)

Parameters	Supply	Exhaust	Unit
Intake			
Temperature	-5	0	°C
Relative humidity	82	82	%
Supply			
Temperature	8,9	10,9	°C
Relative humidity	29	38	%

Acoustic Data

Supply air flow (into air ducts)	Unit
Intake	72
Supply	87
Exhaust air flow (into air ducts)	
Intake	73
Supply	87
Surrounding	56

Parameters	Supply	Exhaust	Unit
Nominal air flow	3000	3000	m ³ /h

Air Filters

Filter class	F5	G4	
Type	Bag filter	Bag filter	
Dimensions b x h x l	592x592x360	592x592x360	mm

Fans Motors

	1100	1100	W
Input power	1100	1100	W
Rotation speed	2850	2850	rpm
Protection level	IP 55	IP 55	IEC 34-5

Plate Heat Exchanger

	55,5		%
Thermal efficiency	55,5		%
Energy recovery	16,7		kW
Air temperature in/out	-10/6,6	20/6,4	°C
Relative humidity in/out	82/22	45/91	%

Electric Air Heater

	18		kW
Capacity	18		kW
Air temperature in/out	1,5/20		°C

Parameters				Unit
Hot Water Air Heater				
Water temperature in/out	90/70	80/60	70/50	°C
Capacity	25,4	21,76	18,2	kW
Flow rate	1117	953	792	dm ³ /h
Pressure drop	4	3	2	kPa
Connection	1			"
Air flow 3000 m ³ /h temperature in/out	0/25,1	0/21,5	0/18	°C

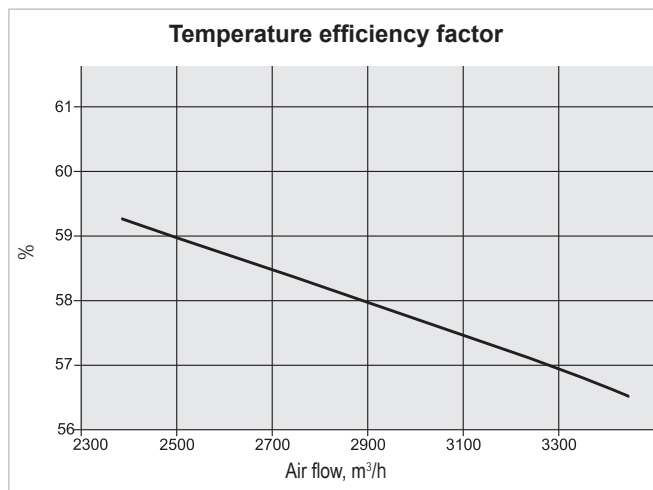

Performance RECU 3000HE

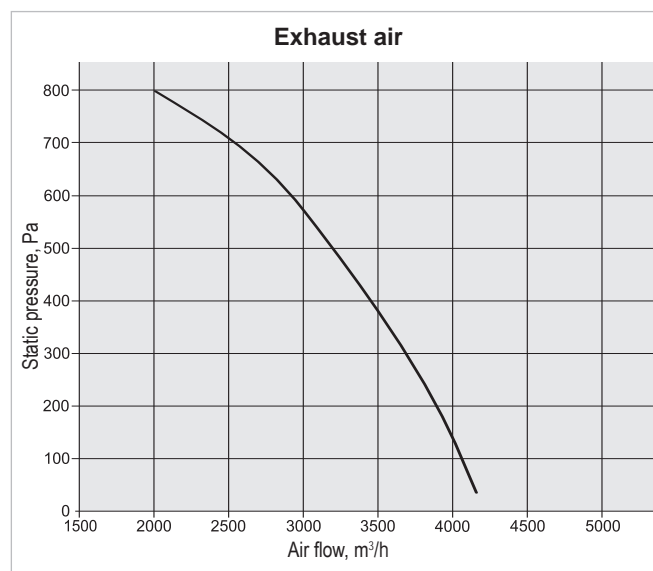
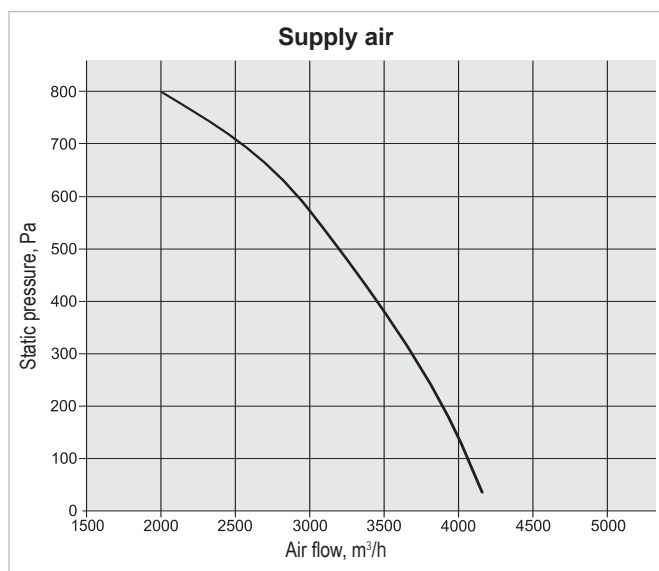

Performance RECU 3000HW

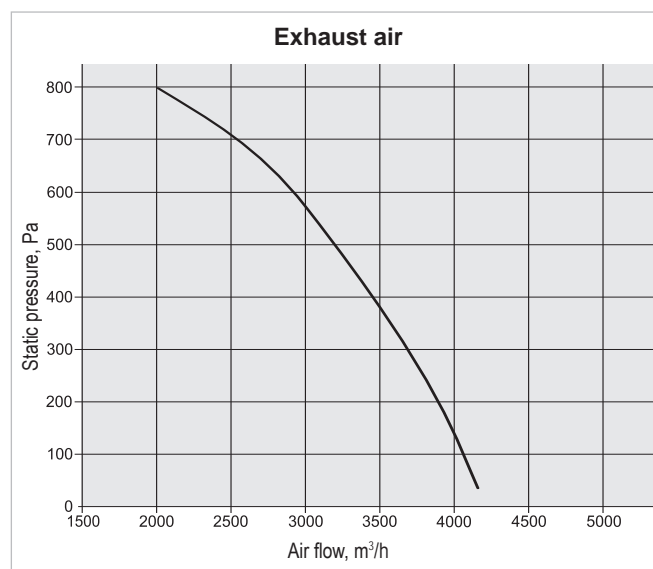
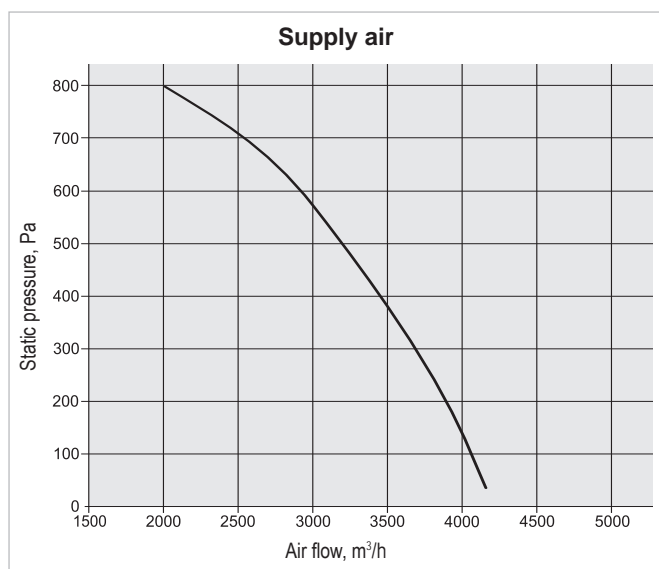

Correction factor for F7 class filter approximately – 70 Pa.