

# KOMFOVENT KOMPAKT RECU 4500

## Technical data

### RECU 4500HE-EC (horizontal)

Panel thickness	45 mm
Unit weight	610 kg
Nominal air flow	4500 m <sup>3</sup> /h
Supply voltage	3~ 400/50 V/Hz
Maximal operating current	40 A
Control system	KOMFOVENT C3

### RECU 4500HW-EC (horizontal)

Panel thickness	45 mm
Unit weight	625 kg
Nominal air flow	4500 m <sup>3</sup> /h
Supply voltage	3~ 400/50 V/Hz
Maximal operating current	5,5 A
Control system	KOMFOVENT C3

### RECU 4500HE-EC (shown as right)

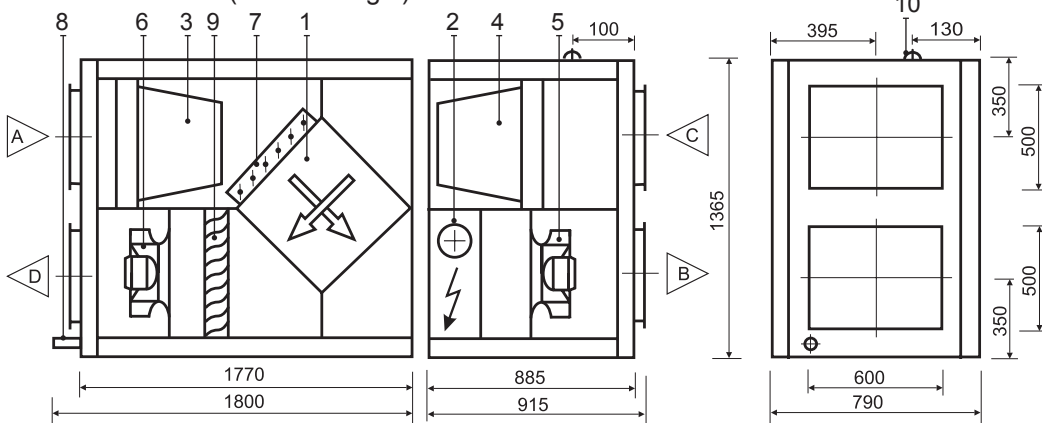

### RECU 4500HW-EC (shown as right)

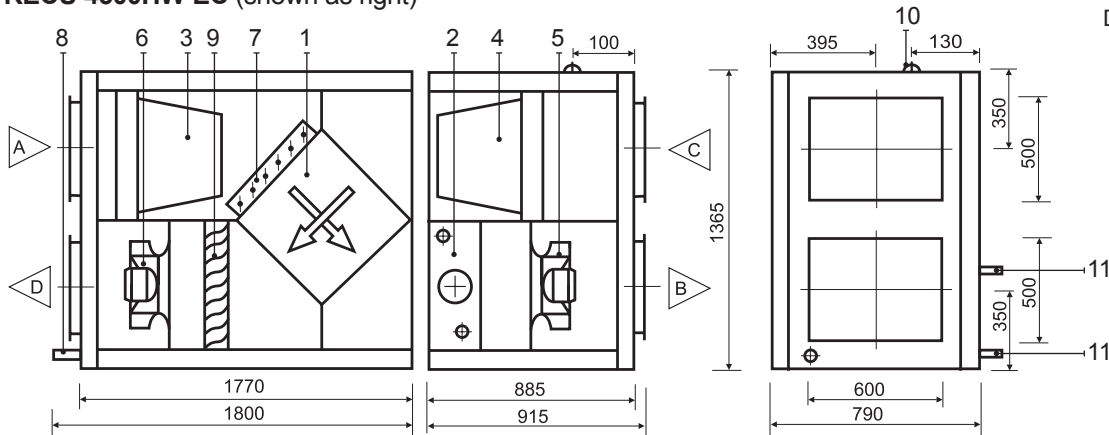

A Outdoor intake  
B Supply air  
C Extract indoor  
D Exhaust air

## Design:

1. Plate heat exchanger
2. Electric or hot water air heater
3. Supply air filter
4. Exhaust air filter
5. Supply fan
6. Exhaust fan
7. Air by-pass damper
8. Condensate drain (the water trap must be installed D=28 mm)
9. Drop eliminator
10. Connection of main cable
11. Fluid connection tube

### Thermal Efficiency (4500 m<sup>3</sup>/h)

Parameters	Supply	Exhaust	Unit
<b>Intake</b>			
Temperature	-5	0	20
Relative humidity	82	82	45
<b>Supply</b>			
Temperature	7,5	10	
Relative humidity	31	41	

Parameters	Supply	Exhaust	Unit
Nominal air flow	4500	4500	m <sup>3</sup> /h

### Air Filters

Filter class	F5	G4	
Type	Bag filter	Bag filter	
Dimensions b x h x l	592x592x300	592x592x300	mm

### Fans Motors

Type	EC	EC	
Input power	1700	1700	W
Rotation speed	2600	2600	rpm
Protection level	IP 54	IP 54	IEC 34-5

### Plate Heat Exchanger

Thermal efficiency	52,2		%
Energy recovery	23,6		kW
Air temperature in/out	-10/5,7	20/7,1	°C
Relative humidity in/out	82/23	45/88	%

### Electric Air Heater

Capacity	24		kW
Air temperature in/out	30/20		°C

Parameters				Unit
<b>Hot Water Air Heater</b>				
Water temperature in/out	90/70	80/60	70/50	°C
Capacity	46	40	34	kW
Flow rate	2021	1751	1484	dm <sup>3</sup> /h
Pressure drop	26	21	15	kPa
Connection	1			"
Air flow 4500 m <sup>3</sup> /h temperature in/out	-5/25	-5/21	-5/17	°C

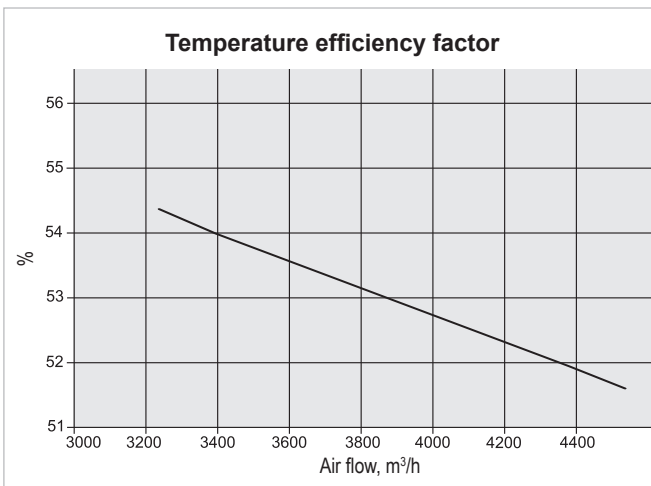

**Performance RECU 4500HE-EC / RECU 4500HW-EC**

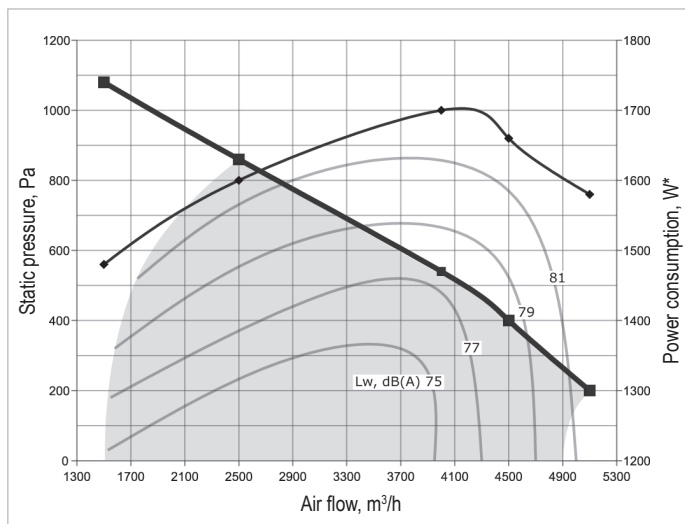

■ - air handling unit working zone.

\* - fans' one motor.

Correction factor for HW approximately – 30 Pa at 4500m<sup>3</sup>/h.

Correction factor for F7 class filter approximately – 70 Pa at 4500m<sup>3</sup>/h.