

KOMFOVENT KOMPAKT REGO 1200

REGO 1200VE-EC

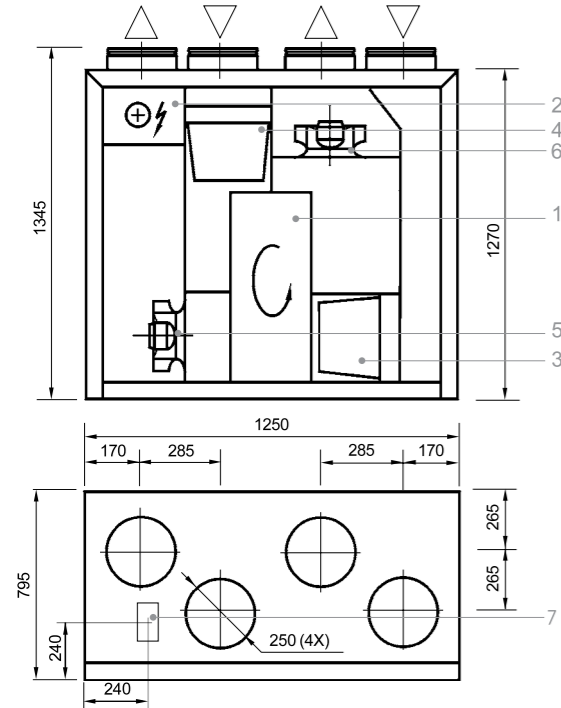

SPECIFICATIONS

REGO 1200VE-EC (vertical)

Panel thickness	45 mm
Unit weight	180 kg
Nominal air flow	1200 m ³ /h
Supply voltage	3~ 400/50 V/Hz
Operating current*	8,7 A
Control system	KOMFOVENT C3

REGO 1200HE-EC (horizontal)

Panel thickness	45 mm
Unit weight	170 kg
Nominal air flow	1200 m ³ /h
Supply voltage	3~ 400/50 V/Hz
Operating current*	8,7 A
Control system	KOMFOVENT C3

* Maximal

- A outdoor intake
- B supply air
- C extract indoor
- D exhaust air

REGO 1200HE-EC

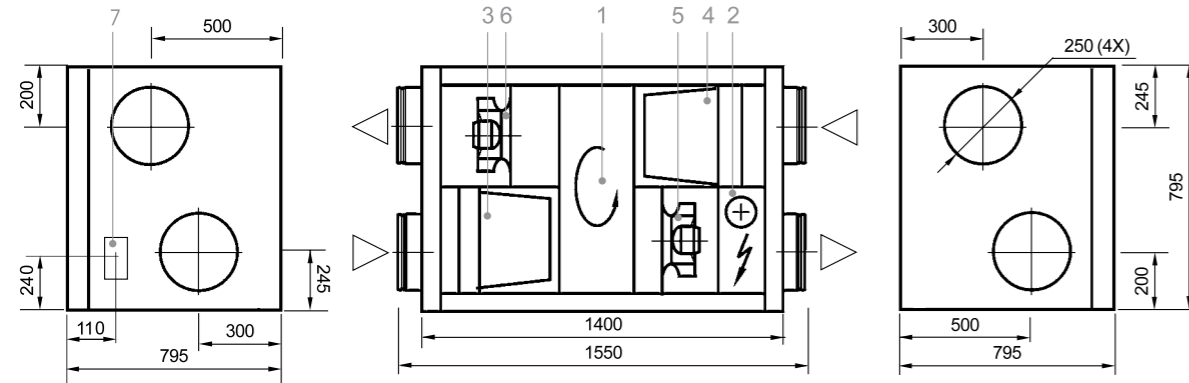

TECHNICAL DATA

Thermal Efficiency (1200m³/h)

Parameters	Supply					Exhaust	Unit
Inlet parameters							
Air temperature	-15	-10	-5	0	20		°C
Relative humidity	82	82	82	82	45		%
Outlet parameters							
Air temperature	11	12,5	13,8	15			°C
Relative humidity	54	46	39	34			%

Design:

1. Rotary heat exchanger
2. Electric air heater
3. Supply air filter
4. Exhaust air filter
5. Supply fan
6. Exhaust fan
7. Main switch

Rotary Heat Exchanger

Air 20°C/ 50%/ 1013 mbar	Supply	Exhaust	Unit
Flow rate	1200	1200	m ³ /h
Velocity	2,5	2,5	m/s
Pressure losses	100	100	Pa
Thermal efficiency		75	%
Energy recovery		13	kW
Inlet parameters			
Air temperature	-23	20	°C
Relative humidity	82	40	%
Outlet parameters			
Air temperature	9,3	-12,3	°C
Relative humidity	68	98	%

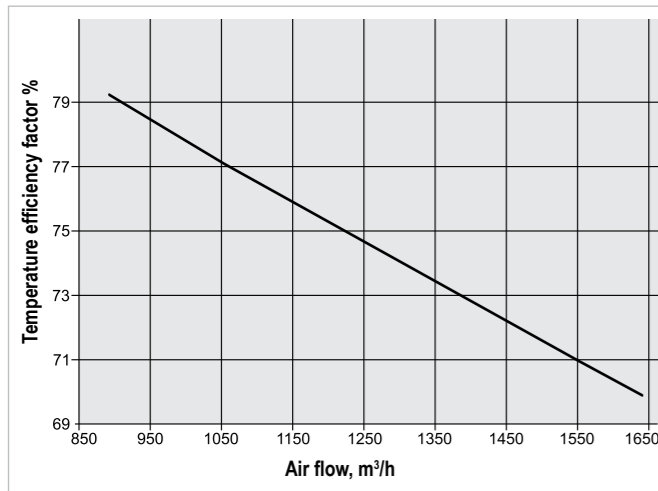

Single-inlet Radial Fans

Parameters	Supply	Exhaust	Unit
Air flow	1200	1200	m ³ /h
Motors			
Type	EC	EC	
Input power	425	425	W
Rotation speed*	2725	2725	rpm
Supply voltage	1~ 230/50	1~ 230/50	V/Hz
Operating current*	2,6	2,6	A
Protection level	IP 54	IP 54	IEC 34-5

Electric Air Heater

Parameters	
Air flow	1200 m ³ /h
Capacity	4,5 kW
Air temperature in/out	9,3/20,4°C
Supply voltage	3~ 400/50 V/Hz

Note: there is an option to connect hot water duct air heater.

* Maximal

PERFORMANCE

REGO 1200VE-EC/REGO 1200HE-EC

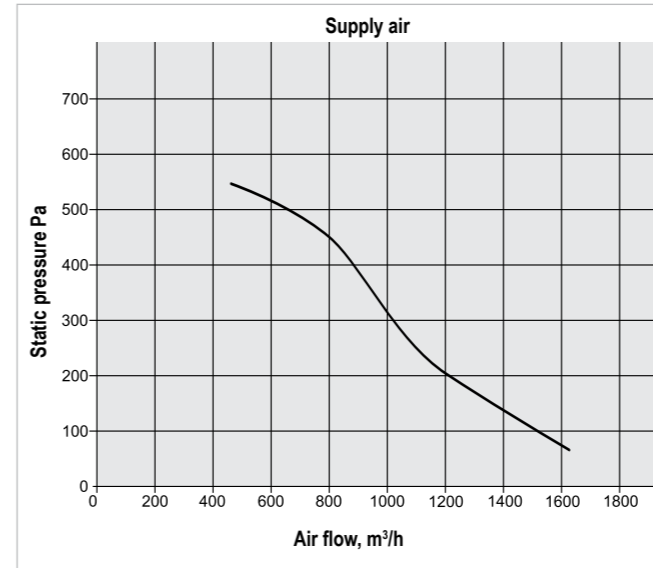

Acoustic Data

	EC				AC		
	max	1 speed	2 speed	3 speed	LwA, dB(A)		
Supply air flow (into air ducts)							
Intake	66	44	48	53			
Supply	73	50	56	61			
Exhaust air flow (into air ducts)							
Extract	64	45	49	57			
Exhaust	77	51	56	61			
Surrounding	51	36	44	49			

Air Filters

Parameters	Supply	Exhaust
Filter class	F5	F5
Type	Bag filter	Bag filter
Dimensions b x h x l, mm	592x287x360	592x287x360

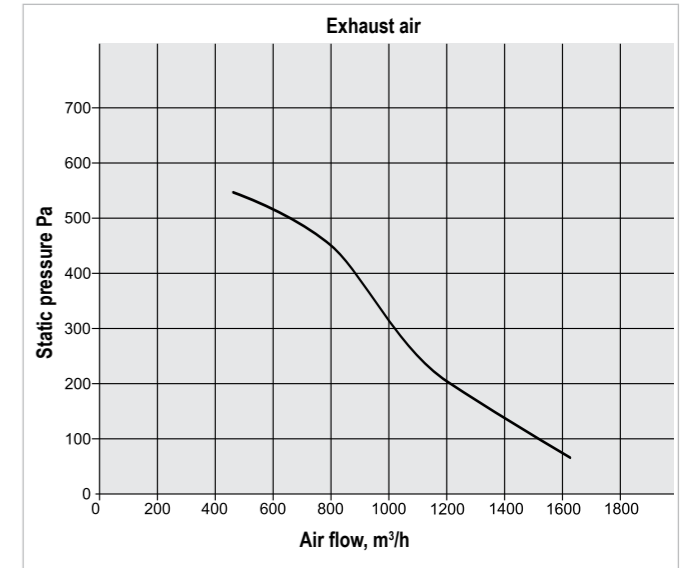

Correction factor for F7 class filter approximately – 70 Pa.