

KOMFOVENT KOMPAKT REGO 900

REGO 900VE-AC/REGO 900VE-EC

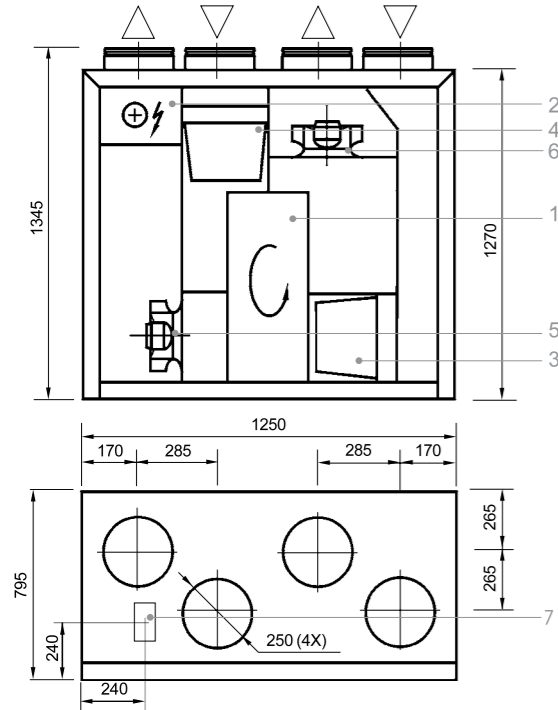

SPECIFICATIONS

REGO 900VE-AC/VE-EC (vertical)

Panel thickness	45 mm
Unit weight	175 kg
Nominal air flow	900 m³/h
Supply voltage	3~ 400/50 V/Hz
Operating current*	6,6/7,8 A
Control system	KOMFOVENT C3

REGO 900HE-AC/HE-EC (horizontal)

Panel thickness	45 mm
Unit weight	165 kg
Nominal air flow	900 m³/h
Supply voltage	3~ 400/50 V/Hz
Operating current*	6,6/7,3 A
Control system	KOMFOVENT C3

* Maximal

- A outdoor intake
- B supply air
- C extract indoor
- D exhaust air

REGO 900HE-AC/REGO 900HE-EC

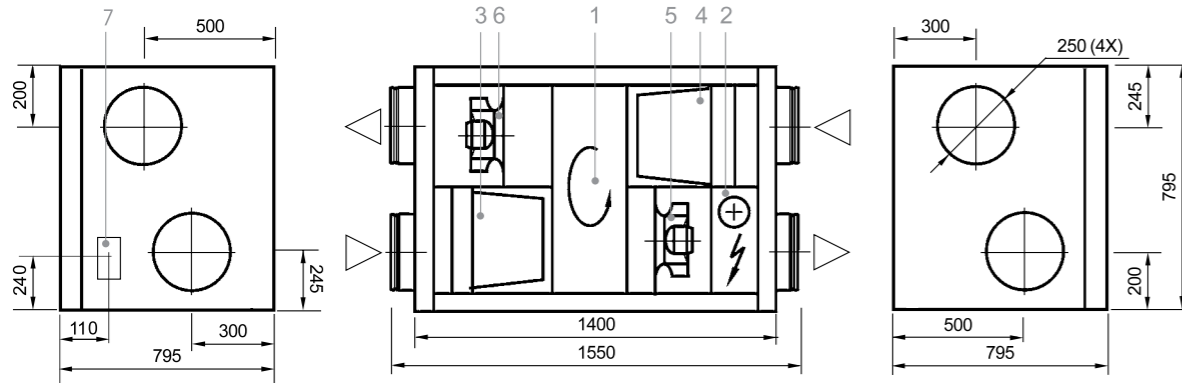

TECHNICAL DATA

Thermal Efficiency (900m³/h)

Parameters	Supply					Exhaust	Unit
Inlet parameters							
Air temperature	-15	-10	-5	0	20		°C
Relative humidity	82	82	82	82	45		%
Outlet parameters							
Air temperature	12,7	13,5	14,8	15,8			°C
Relative humidity	52	45	39	35			%

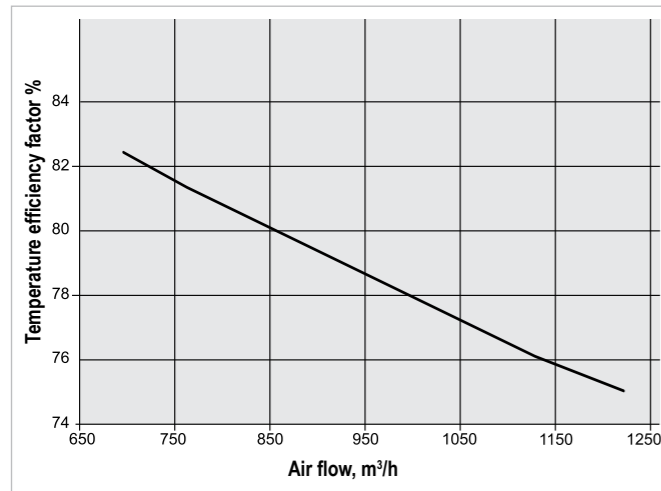

Design:

1. Rotary heat exchanger
2. Electric air heater
3. Supply air filter
4. Exhaust air filter
5. Supply fan
6. Exhaust fan
7. Main switch

Rotary Heat Exchanger

Air 20°C/ 50%/ 1013 mbar	Supply	Exhaust	Unit
Flow rate	900	900	m³/h
Velocity	1,9	1,9	m/s
Pressure losses	73	73	Pa
Thermal efficiency		79,2	%
Energy recovery		10,3	kW
Inlet parameters			
Air temperature	-23	20	°C
Relative humidity	82	40	%
Outlet parameters			
Air temperature	11	-14	°C
Relative humidity	63	98	%

Single-inlet Radial Fans

Parameters	Supply	Exhaust	Unit
Air flow	900	900	m³/h
Motors			
Type	AC/EC	AC/EC	
Input power	230/425	230/425	W
Rotation speed*	2700/2725	2700/2725	rpm
Supply voltage	1~ 230/50	1~ 230/50	V/Hz
Operating current*	1/2,6	1/2,6	A
Protection level	IP 44/54	IP 44/54	IEC 34-5

Electric Air Heater

Parameters	
Air flow	900 m³/h
Capacity	3 kW
Air temperature in/out	11/21 °C
Supply voltage	3~ 400/50 V/Hz

Note: there is an option to connect hot water duct air heater.

* Maximal

PERFORMANCE

REGO 900VE-AC/REGO 900HE-AC

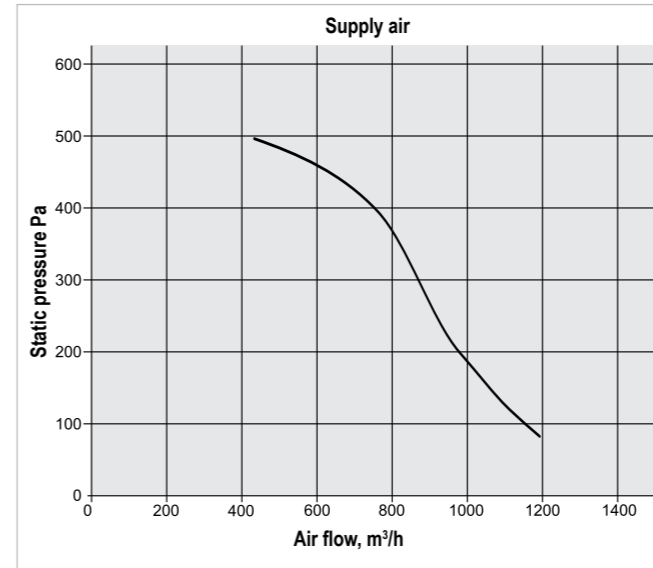

REGO 900VE-EC/REGO 900HE-EC

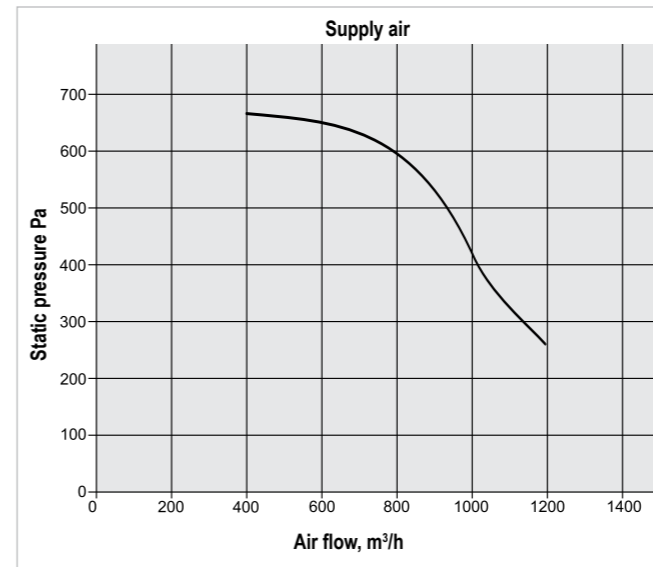

Correction factor for F7 class filter approximately – 70 Pa.

Acoustic Data

	EC		AC	
	max	1 speed	2 speed	3 speed
Supply air flow (into air ducts)				
Intake	66	52	61	67
Supply	73	59	69	75
Exhaust air flow (into air ducts)				
Extract	64	52	62	68
Exhaust	77	59	69	75
Surrounding	51	38	42	50

Air Filters

Parameters	Supply	Exhaust
Filter class	F5	F5
Type	Bag filter	Bag filter
Dimensions b x h x l, mm	592x287x360	592x287x360